

Getting started

Quick tips about your new phone

Made with a Mission

Firefox OS was created to free you from the rules and restrictions imposed by other mobile phones and give you control over the information you store and share. It's made by Mozilla as part of our mission to put the power of the Web in everyone's hands.

Power on

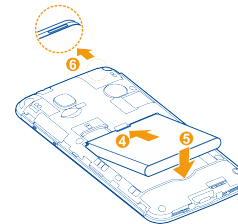
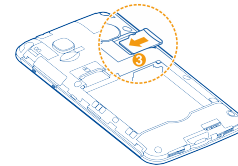
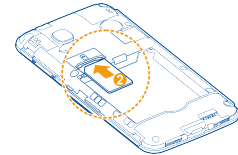
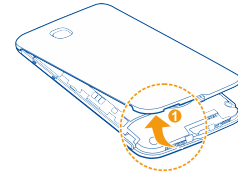

Unlock phone

Drag the arrow towards right to unlock your phone.
If the screen is off, press the Power button.

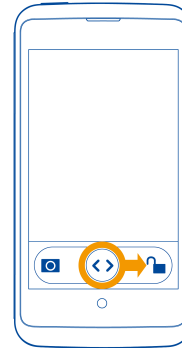

Navigate Home

Swipe right for Everything and left for all your apps.

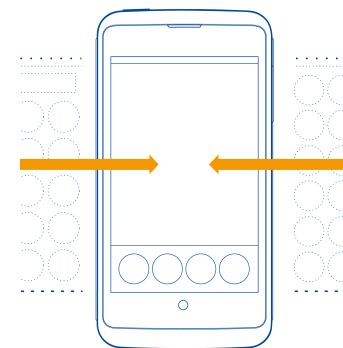

Personalize Home

Touch and hold an icon to move or delete it. Drag icons in and out of the Dock for quick access from the Home.

Touch the Home button when you finish.

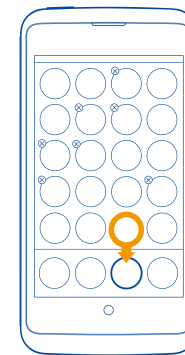

Customize wallpaper

Touch and hold the wallpaper to select a new one.

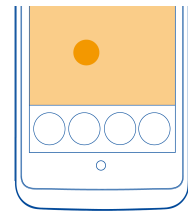

Open notifications

Drag the Status Bar down to see notifications, quick settings, and your mobile data use. Touch a notification to go to the related app.

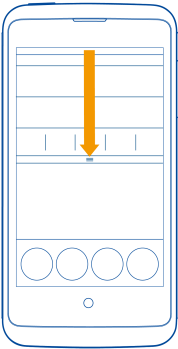

Switch applications

Touch and hold the Home button and then swipe to see other open apps. Touch an app to switch to it.

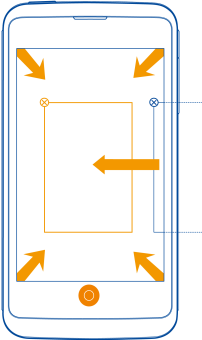

Connect to a computer

Insert a microSDHC™ card. Then turn on USB storage in the phone settings and transfer all your photos and music.



Manage mobile data

Turn your Internet connection on and off from the phone settings or quick settings.

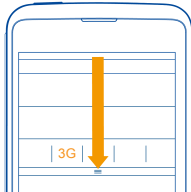
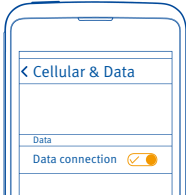

Product Safety Information

	Do not hold phone while driving
	Do not use while re-fuelling
	When calling, keep the phone at least 15 mm from your ear
	This device may produce a bright or flashing light
	Small parts may be a choking hazard
	Do not dispose of device in a fire
	The phone may produce a loud sound
	To prevent possible hearing damage, do not listen for long periods at high volume levels
	Avoid contact with magnetic materials
	Avoid extreme temperatures
	Keep away from pacemakers and other personal medical devices
	Avoid any contact with liquids
	Switch off when instructed in hospitals and medical facilities
	Do not attempt to disassemble
	Switch off when instructed in aircrafts and airports
	Only use approved accessories

	Switch off in explosive environments
	Do not rely on this device for emergency communication

LEGAL INFORMATION

Copyright © 2014 ZTE CORPORATION.

All rights reserved.

No part of this publication may be quoted, reproduced, translated or used in any form or by any means, electronic or mechanical, including photocopying and microfilm, without the prior written permission of ZTE Corporation.

Notice

ZTE Corporation reserves the right to make modifications on print errors or update specifications in this guide without prior notice.

Disclaimer

ZTE Corporation expressly disclaims any liability for faults and damages caused by unauthorized modifications of the software.

Images and screenshots used in this guide may differ from the actual product. Content in this guide may differ from the actual product or software.

We offer self-service for our smart terminal device users. Please visit ZTE official website (at <http://www.ztedevice.com>) for more information on self-service and supported product models. Information on the website takes precedence.

Trademarks

ZTE and the ZTE logos are trademarks of the ZTE Corporation.

The *Bluetooth*® trademark and logos are owned by the Bluetooth SIG, Inc. and any use of such trademarks by ZTE Corporation is under license.



microSDHC Logo is a trademark of SD-3C, LLC.

Other trademarks and trade names are the property of their respective owners.

Manual No. : 979584590011