

ZTE N818 CDMA/GSM Mobile Phone Quick Start Guide

LEGAL INFORMATION

Copyright © 2013 ZTE CORPORATION.
All rights reserved.

No part of this publication may be quoted, reproduced, translated or used in any form or by any means, electronic or mechanical, including photocopying and microfilm, without the prior written permission of ZTE Corporation.

Notice

ZTE Corporation reserves the right to make modifications on print errors or update specifications in this guide without prior notice.

We offer self-service for our smart terminal device users. Please visit the ZTE official website (at www.zte.com.cn) for more information on self-service and supported product models. Information on the website takes precedence.

Disclaimer

ZTE Corporation expressly disclaims any liability for faults and damages caused by unauthorized modifications of the software.

Images and screenshots used in this guide may differ from the actual product. Content in this guide may differ from the actual product or software.

Trademarks

ZTE and the ZTE logos are trademarks of the ZTE Corporation.

Google and Android are trademarks of Google, Inc.

The Bluetooth® trademark and logos are owned by the Bluetooth SIG, Inc. and any use of such trademarks by ZTE Corporation is under license.

The microSD logo  is a trademark of the SD Card Association.

Other trademarks and trade names are the property of their respective owners.

Version No.: R1.0

Edition Time: 20130705

Manual No.: 添加物料代码

Getting to Know Your Phone

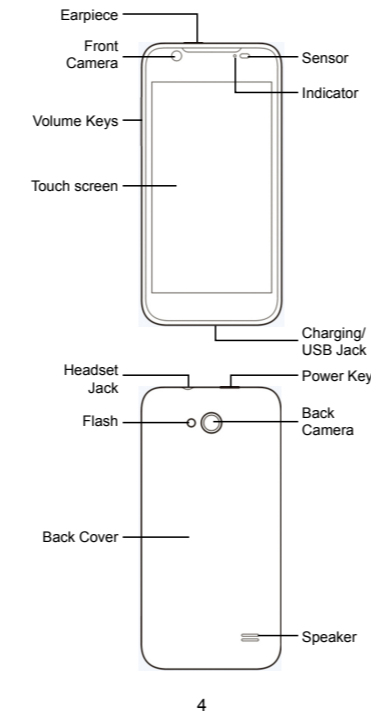

Checking the Phone Status

The status bar at the top of the screen displays phone and service status with various icons on the right side. Below are some of the icons and their meanings.

	System connected		No signal
	Mobile data in use		Signal strength
	Flight mode		Bluetooth on
	Ringer off		Connected to a Wi-Fi network
	Vibrate mode		Wi-Fi in use
	Battery low		Phone microphone off
	Battery full		Alarm set
	Battery charging		Battery partially drained
	No UIM/SIM card installed		Wired headset connected

3. If needed, drag more shortcuts and drop them into the folder.

Applying New Wallpapers

You can set the wallpaper for the home screen or lock screen.

1. Touch > > **Settings** > **Display** > **Wallpaper**.
2. Select a wallpaper source from **E•Surfing Wallpapers**, **Gallery**, **Live Wallpapers**, or **Wallpapers** and touch the image or animation you want to use as the wallpaper. Some cropping might be needed for the gallery pictures.
3. Touch SET **WALLPAPER**.

Knowing the Navigation Bar and Mi-POP

The navigation bar is usually at the bottom of the screen. By touching , , and , you can get back to the previous screen, get back to Home, and view the recently used apps.

Mi-POP offers an efficient way to use the device. When it is enabled, the navigation bar could be replaced, and larger screen area will be available. Meanwhile, you will see the float Mi-POP icon on some part of the screen.

Power Key

- Press and hold to power on, reset, turn on/off airplane mode, or select phone modes.
- Press to turn off or on the screen display.

Volume Keys

Press or hold to turn the volume up or down.

Starting Up

Switch off your phone before installing or replacing the battery or the UIM/SIM card. The microSD card is optional and can be installed and removed while the phone is turned on. Unmount the microSD card before removing it.

1. Place your finger in the slot at the bottom of the back cover to lift and remove the cover.

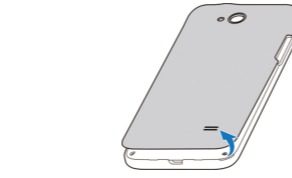

2. Hold the UIM/SIM card with its cut corner oriented as shown and slip it into the card holder.

	USB connected		GPS on
	Song is playing		

Setting Ringtone and Sounds

Setting Ringtone or Notification Sound

1. Touch > > **Settings** > **Sound**.
2. Touch **Phone ringtone** or **Default notification**.
3. Select the ringtone you want to use.
4. Touch **OK**.

Setting System Sounds

1. Touch > > **Settings** > **Sound**.
2. Scroll to the **SYSTEM** section and check the sounds you want to hear or uncheck those you do not need.

Adjusting Volumes

To adjust call volume, press the **Volume Keys** while on a call. To adjust other volumes, follow the steps below.

1. Touch > > **Settings** > **Sound** > **Volumes**.

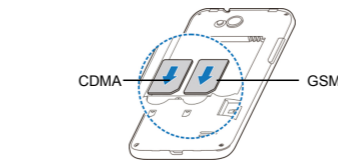

3. Hold your microSD card with the metal contacts facing down and slide it into the microSD card slot.

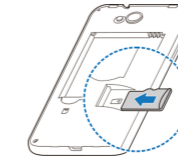

NOTE: Your phone may come with a pre-installed microSD card. Some applications may not function normally after you remove the card, pre-installed or otherwise.

4. Align the connectors on the phone and the battery and slide the battery into the compartment. Then gently press the battery down until it is secured.

6

2. Drag the sliders to adjust the volume for music, video, games, and other media, the ringtone and notification volume, and the alarm volume.
 3. Touch **OK** to save.
- TIP:** Press and hold the **Power Key** and then touch to enable the silent mode, touch to enable the vibration mode, or touch to disable the silent mode.

Setting a Screen Lock

You can protect your phone by creating a screen lock. When enabled, you need to touch and hold an icon, look at the device, draw a pattern, or enter a numeric PIN or password to unlock the phone's screen and keys.

1. Touch > > **Settings** > **Security** > **Screen lock**.
2. Touch **Long press**, **Face Unlock**, **Pattern**, **PIN** or **Password**.

▶ Touch **Long press** to enable unlock with a 'touch and hold' gesture. You can unlock the screen by touching and holding at the center of the display.

14

Charging the Battery

1. Connect the adapter to the charging jack. Ensure that the adapter is inserted with the correct orientation. Do not force the connector into the charging jack.

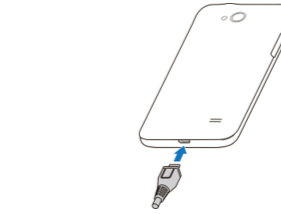

2. Connect the charger to a standard AC power outlet.
3. Disconnect the charger when the battery is fully charged.

7

- ▶ Touch **Face Unlock** to let the phone capture your face. You can unlock the screen by looking at the phone. You also need to set a pattern or PIN in case the phone cannot recognize your face.
- ▶ Touch **Pattern** to create a pattern that you must draw to unlock the screen.
- ▶ Touch **PIN** or **Password** to set a numeric PIN or a password you must enter to unlock your screen.

Making a Call

1. Touch > .
2. In the dialer tab , enter the phone number with the on-screen keypad. Touch to delete incorrect digits.
3. Touch the icon below the keypad to place the call.

NOTE: To call a contact, touch > > and touch a contact and number.

15

Powering On/Off Your Phone

Make sure the battery is charged before powering on.

- Press and hold the **Power Key** to turn on your phone.
- To turn it off, press and hold the **Power Key** to open the options menu. Touch **Power off** (or **Power Off (Fast)**) > **OK**.

Getting to Know the Home Screen

The home screen is the starting point for your phone's applications, functions, and menus. You can customize your home screen by adding application shortcuts, folders, widgets, and more.

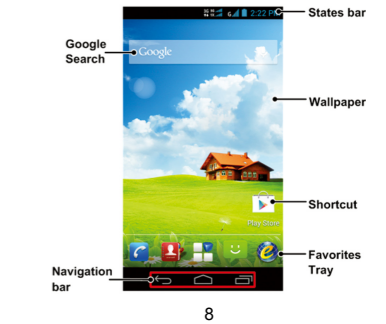

8

Adding Contacts

Creating a New Contact

1. Touch > and touch the all contacts tab .
2. Touch .
3. If prompted, select an account to synchronize your new contact.
4. Enter the contact name, phone numbers, email addresses, and other information, as shown. Touch **DONE** to save the contact.

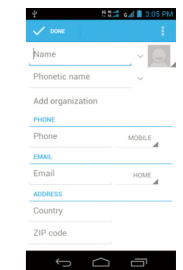

16

1

2

3

4

5

9

10

11

12

13

14

15

16

Importing Contacts in Batches

1. Touch > > > **Import from UIM/SIM card or Import from storage.**
2. If prompted, select an account from which to import the contacts.
3. If prompted, select an account in which to save the contacts.
4. For importing from the UIM/SIM card, touch all the UIM/SIM contacts you want to import and touch **OK**.
5. For importing from the microSD card, select the vCard file(s) on the microSD card and touch **OK** to begin importing.

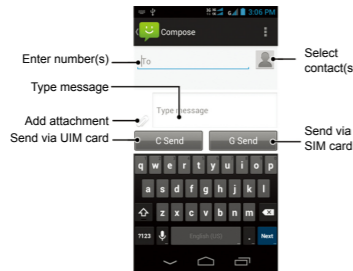

Setting Up Email Accounts

Setting Up Gmail

1. Touch > > > **Gmail.**
NOTE: If another Gmail account is already set up, touch > **Settings** > **ADD ACCOUNT.**
2. Touch **Existing** to sign in to your existing Google Account. If you have no Google Accounts, touch **New** to create one.
3. Follow the instructions on the screen to set up the account.

17

Playing Music

1. Touch > > **Play Music.**
2. Touch a category, such as Artists or Albums, to find the song you want to play.
3. Touch the song to play it.

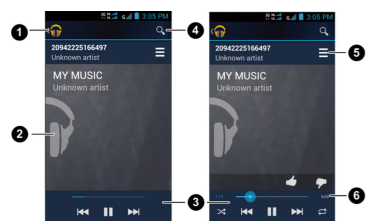

Number	Function
1	Touch to view the current playing list.
2	Album artwork.
3	Playback control. Skip songs, pause and resume playback, use shuffle or repeat. Drag the progress bar to jump to any part of the song.
4	Search for music.
5	Back to Now playing list.
6	Rate the song.

25

Setting Up Email

1. Touch > > **Email.**
NOTE: If another email account is already set up, touch > **Settings** > **ADD ACCOUNT.**
2. Select the email server you want to use.
3. Enter the email address and password.
4. Touch **Next** and follow the onscreen instructions.

Setting Up Corporate Exchange Email

1. Touch > > **Email.**
NOTE: If another email account is already set up, touch > **settings** > **ADD ACCOUNT.**
2. Select the email server you want to use.
3. Enter the email address and password.
4. Touch **Manual setup** > **Exchange.**
5. Enter **Domain**(Username, Password, and Server information.
6. Read the onscreen activation disclaimer and, if prompted, touch **Next**.
7. If prompted, touch **OK** to allow the server to remotely control some of your phone's security features.
8. Configure the settings on the screen, such as **Days to sync**, and then touch **Next**.
9. If prompted, touch **Activate** to activate the Email app as a device administrator.

19

To disconnect the device from the computer, simply unplug the USB cable when you're finished.

Connecting to the Internet

Connecting via Wi-Fi

1. Touch > > **Settings** > **Wi-Fi.**
2. Slide the **ON/OFF** switch if Wi-Fi is off.
Your phone automatically searches for Wi-Fi networks in range and displays their names and security settings. Your phone also connects to previously linked networks when they are in range.
3. Touch a network name to connect to it.
If the network is secured, enter a password or other credentials. (Ask your network administrator for details.)

Connecting via Mobile Network

To connect to the Internet via mobile network you can use the default Access Point Names (APN). And if you want to add a new APN, please contact the service provider to get the necessary information. Do not change the settings as the service might stop working.

1. Touch > > **Settings** > **More** > **Mobile networks** > **CDMA/GSM** > **Access Point Names.**

10. Identify your new account with a unique name and then touch **Next**.
Contact your server administrator for more help.

Connecting With a Bluetooth Headset

1. Turn on the Bluetooth headset and switch it to pairing mode. Refer to the headset's user guide for more information.
2. Touch > > **Settings** > **Bluetooth.**
3. Slide the **ON/OFF** switch if Bluetooth is off. When Bluetooth is on, the icon appears in the status bar.
NOTE: Your phone automatically scans for and displays the IDs of all available Bluetooth devices in range. You could touch **SEARCH FOR DEVICES** if you wanted to scan again.
4. Touch the ID of the headset, or any other device you want to pair with your phone. Enter a passcode if prompted.
5. If necessary, touch the ID of the paired headset to connect with it. Once connected, the icon in the status bar turns blue.
TIP: Touch next to the ID of the headset, and touch **Unpair** to end the connection.

20

2. Touch > **New APN.**
3. Touch each item to enter the information you get from your service provider.
4. Touch > **Save** to complete.

Connecting via Bluetooth Tethering

You can connect to a device that supports Bluetooth tethering to sharing the device's Wi-Fi or mobile data service with your phone.

1. Enable the device's Bluetooth and Bluetooth tethering capabilities. Make sure the device is 'visible'. Refer to the device's user guide for more information.
2. Touch > > **Settings** > **Bluetooth.**
3. Turn Bluetooth on and touch the device's ID to pair the phone with the device. Enter a passcode if prompted.
4. Touch the ID of the paired device to connect with it. As the icon in the status bar turns blue, your phone is able to use data connection shared by the device.

28

Installing Apps From the Google Play Store

There are tens of thousands of games and applications in the Google Play Store for you to download and install. You can send feedback or comments on an application.
Before you begin, make sure that you have signed in to your Google account.

NOTE: The content you can access in the Play Store depends on your region and your service provider.

1. Touch > > **Play Store.**
The first time you launch **Play Store**, accept the Google Play Terms of Service.
2. Find the apps you need either by category or by touching .
3. Touch the app to see detailed description.
4. Touch **Install** (free apps) or the price (paid apps). If the app is not free, you need to sign in to your Google Wallet account and select a payment method.

21

Extending Battery Life

There are several things you can do to make your battery last longer.

- Turn on Wi-Fi, Bluetooth, GPS, mobile data, auto-sync only when you need to.
- Lower the screen brightness.
- Use Bluetooth tethering or USB tethering (when you have a cable) instead of portable Wi-Fi hotspot to share your phone's data service.
- From the home screen, touch > **Task Manager** and close the apps you do not need but still run in the background.
- From the home screen, touch > **Settings** > **Sound** and uncheck **Vibrate on touch**.

Freeing Up Memory Space

Use **Task Manager** to free up memory space and optimize system speed.

1. From the home screen, touch > **Task Manager**.
2. Touch the **Tasks** tab and touch next to the application you do not need.
You can also touch **CLOSE ALL** to stop all running applications.

29

CAUTION: Once installed, some apps can access many functions or a significant amount of your personal data. The Play Store will show you what the app can access. Touch **Accept & download** (free apps) or **Accept & buy** (paid apps) to proceed, or touch to cancel.

5. Wait for the app to be downloaded and installed automatically. Payment needs to be authorized before paid apps start downloading.

The app is successfully installed when the icon appears in the status bar. You can find the new app after touching > .

22

Managing the Phone Storage

Deleting Old Messages

You can manually delete old messages to free up some storage space. You may also set up auto deletion of the oldest messages when the limits are reached.

1. From the home screen, touch > > **Messages.**
2. Touch > **Settings.**
3. Check **Delete old messages** to enable auto deletion.
4. Touch **Text message limit** or **Multimedia message limit** to set the maximum limit.
5. Touch **Set**.

Clearing Browser's Local Content

1. From the home screen, touch > **Browser.**
2. Touch > **Settings** > **Privacy & security.**
3. Touch **Clear cache**, **Clear history**, and **Clear all cookie data**.

30

Taking a Photo

1. Touch > > **Camera.**
2. Aim the camera at the subject and make any necessary adjustment.

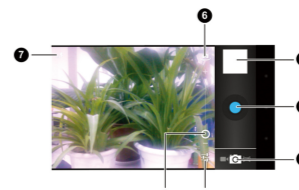

Number	Function
1	Change the camera settings.
2	Hold the circle and slide to zoom in or out.
3	Switch to the camcorder or panorama camera.
4	Capture a photo.
5	View photos and videos you have captured.
6	Switch between the front camera and the back camera.
7	Show the current flash mode.

3. Lightly touch the blue button .

23

Product Safety Information

	Do not use hand-held while driving
	Do not use while re-fuelling
	For body-worn operation maintain a separation of 15 mm
	This device may produce a bright or flashing light
	Small parts may cause a choking hazard
	Do not dispose of it in a fire
	This device may produce a loud sound
	To prevent possible hearing damage, do not listen at high volume levels for long periods.
	Avoid contact with magnetic media
	Avoid Extreme Temperatures
	Keep away from pacemakers and other personal medical devices

31

Recording a Video

1. Touch > > **Camera**, and switch to the camcorder mode.
2. Aim the camera at the subject and make any necessary adjustment.

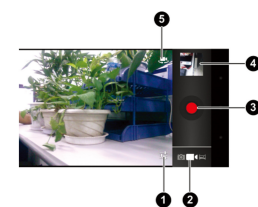

Number	Function
1	Change the camcorder settings.
2	Switch to the camera or panorama camera.
3	Start or stop recording a video.
4	View photos and videos you have captured.
5	Switch between the front camera and the back camera.

3. Touch to start and to stop recording.

24

	Avoid any contact with liquid, keep it dry
	Switch off when instructed in hospitals and medical facilities
	Do not attempt to disassemble
	Switch off when instructed in aircrafts and airports
	Only use approved accessories
	Switch off in explosive environments
	Do not rely on this device for emergency communications

32