

ZTE Switch X1

Quick Start Guide

LEGAL INFORMATION

Copyright © 2015 ZTE CORPORATION.

All rights reserved.

No part of this publication may be quoted, reproduced, translated or used in any form or by any means, electronic or mechanical, including photocopying and microfilm, without the prior written permission of ZTE Corporation. ZTE Corporation reserves the right to make modifications on print errors or update specifications in this guide without prior notice. We offer self-service for our smart terminal device users. Please visit ZTE official website (at www.ztedevice.com) for more information on self-service and supported product models. Information on the website takes precedence.

Disclaimer

ZTE Corporation expressly disclaims any liability for faults and damages caused by unauthorized modifications of the software.

Trademarks

ZTE and the ZTE logos are trademarks of the ZTE Corporation.

Google and Android are trademarks of Google, Inc.

The *Bluetooth*® trademark and logos are owned by the Bluetooth SIG, Inc. and any use of such trademarks by ZTE Corporation is under license.

microSDHC logo  is a trademark of the SD-3C, LLC.

Qualcomm®
snapdragon 

Qualcomm® Snapdragon™ processors are products of Qualcomm Technologies, Inc. Qualcomm and Snapdragon are trademarks of Qualcomm Incorporated, registered in the United States and other countries. Used with permission. Other trademarks and trade names are the property of their respective owners.

Version No.: R1.0

Edition Time: March 26, 2015

Getting to Know Your Phone

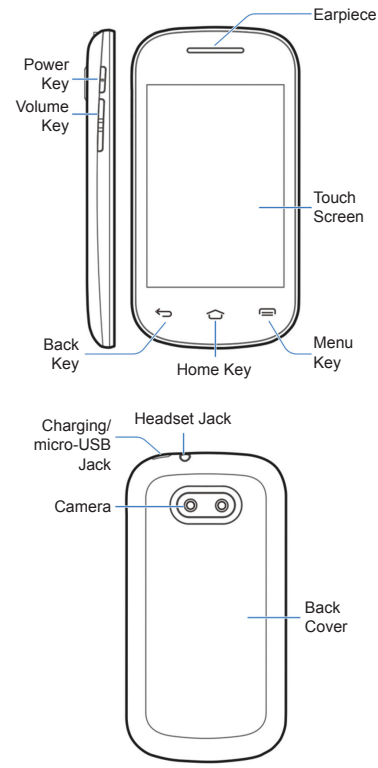

Power Key

- Press and hold to power on, turn on/off silent mode, turn on/off airplane mode, or power off.
- Press to turn off or on the screen display.

Volume Key

Press or hold either end to turn the volume up or down.

Home Key

- Touch to return to the home screen from any application or screen.
- Touch and hold to use Google search.

Menu Key

- Touch to get options for the current screen.
- Touch and hold to see recently used apps.

Back Key

Touch to go to the previous screen.

Before Getting Started

Switch off your phone before installing or replacing the battery, microSDHC™ card, or the SIM card. The microSDHC card is optional.

1. Place your finger in the slot at the bottom of the back cover to lift and remove the cover.

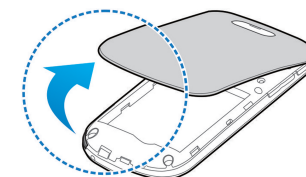

2. Hold the SIM card with its cut corner oriented as shown and slip it into the card holder.

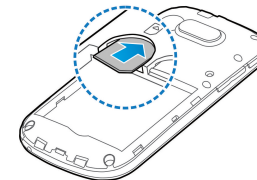

3. Hold your microSDHC card with the metal contacts facing down and slide it into the microSDHC card slot.



NOTE:

Some applications may require a microSDHC card to store certain data on it and to work properly. Therefore, it is recommended that you keep a microSDHC card installed and not remove or replace it unnecessarily.

4. Align the connectors on the phone and the battery and slide the battery into the compartment. Then gently press the battery down until it is secured.

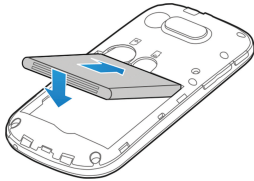

5. Align the back cover with the back of the phone and press the cover back into place. Ensure that all the tabs are secure and there are no gaps around the cover.

Charging the Battery

When you first get your new phone you'll need to charge the battery.

⚠ WARNING!

Use only ZTE-approved chargers and cables. The use of unapproved accessories could damage your phone or cause the battery to explode.

1. Connect the adapter to the charging jack. Ensure that the adapter is inserted with the correct orientation. Do not force the connector into the charging jack.

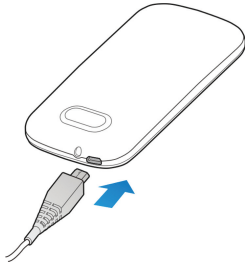

2. Connect the charger to a standard AC power outlet.
3. Disconnect the charger when the battery is fully charged.

Powering On/Off

Ensure that the battery is charged before powering on.

- Press and hold the **Power Key** to turn on your phone.
- To turn it off, press and hold the **Power Key** to open the options menu. Touch **Power off** and then touch **OK**.

Waking Up Your Phone

Your phone automatically goes into sleep mode when it is not in use for some time. The display is turned off to save power and the keys are locked to prevent accidental operations. You can wake up phone by turning on the display and unlocking the keys.

1. Press the **Power Key** to turn the screen on.
2. Touch and hold  at the center of the display.

📌 NOTE:

If you have set an unlock pattern, a PIN or a password for your phone, you'll need to draw the pattern or enter the PIN/password to unlock.

Using the Touch Screen

Your phone's touch screen lets you control actions through a variety of touch gestures.

- Touch
When you want to type using the onscreen keyboard, select items onscreen such as application and settings icons, or press onscreen buttons, simply touch them with your finger.
- Touch and Hold
To open the available options for an item (for example, a message or link in a web page), touch and hold the item.

- Swipe or Slide
To swipe or slide means to quickly drag your finger vertically or horizontally across the screen.
- Drag
To drag, press and hold your finger with some pressure before you start to move your finger. While dragging, do not release your finger until you have reached the target position.
- Pinch
In some apps (such as Maps, Browser, and Gallery), you can zoom in and out by placing two fingers on the screen at once and pinching them together (to zoom out) or spreading them apart (to zoom in).
- Rotate the screen
For most screens, you can automatically change the screen orientation from portrait to landscape by turning the phone sideways.

Product Safety Information

C E 0700

| | |
|---|---|
|  | Don't make or receive phone calls while driving. Never text while driving. |
|  | For body-worn operations, maintain a separation of 15 mm. |
|  | Small parts may cause choking. |
|  | Your phone can produce a loud sound. |
|  | To prevent possible hearing damage, do not listen at high volume levels for long periods. |
|  | Avoid contact with anything magnetic. |
|  | Keep away from pacemakers and other electronic medical devices. |
|  | Turn off when asked to in hospitals and medical facilities. |
|  | Turn off when told to on aircraft and at airport. |

| | |
|---|--|
|  | Turn off when near explosive materials or liquids. |
|  | Don't use at gas stations. |
|  | Your phone may produce a bright or flashing light. |
|  | Don't dispose of your phone in fire. |
|  | Avoid extreme temperatures. |
|  | Avoid contact with liquids. Keep your phone dry. |
|  | Do not attempt to disassemble your phone. |
|  | Only use approved accessories. |
|  | Don't rely on your phone as a primary device for emergency communications. |