

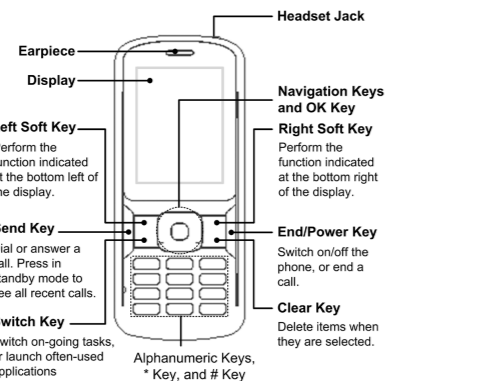

## ZTE F116 Quick Start Guide

### Phone Overview



### Installing the (U)SIM, Memory Card and Battery

1. Make sure that the phone is powered off and the charger is disconnected from the phone.
2. Turn the phone over, hook the edge of the back cover and lift it up to remove the back cover.

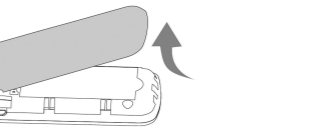

3. Hold your (U)SIM card with the cut corner oriented as shown above the (U)SIM card slot and then slide it into the slot.

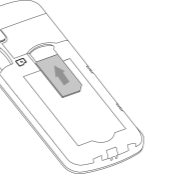

4. Slip the memory card carefully into the microSD card slot with the metal contacts facing downwards.

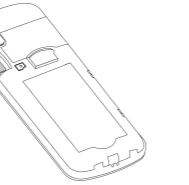

- Note:  
The microSD logo is a trademark of SD Card Association.
5. Insert the battery by aligning the gold contacts on the battery with the gold contacts in the battery compartment on the phone.

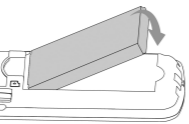

### Charging Your Phone

Please charge your phone before initial use. The plug and socket are keyed so they will only fit together one way.

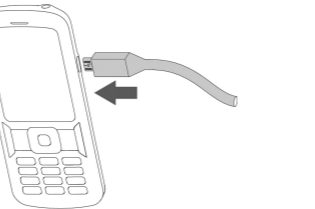

### Powering On/Off

1. Hold the **End Key** to power on the phone.  
Note:  
When being asked, enter your PIN code or handset code, and press the **OK Key** to confirm.
2. To power off the phone, hold the **End Key** from the standby mode.

### Lock/Unlock Your Phone

- In the standby mode, hold the **\* Key** to lock your phone.
- In the main menu, select **Settings > Phone > Auto keyguard** and set the desired time to lock the phone.
- If you want to unlock your phone, press the **OK Key**, and then press the **\* Key**.

Tip:  
If the call is coming when the phone is locked, please press the **Send Key** to answer. After ending or rejecting the call, the keypad will be locked automatically.

### Standby Mode

The startup screen below is referred to throughout the guide as the standby mode.

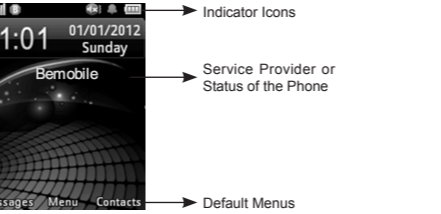

You can always return to the standby mode by pressing the **End Key**.

### Indicators and Icons

	Signal strength		Alarm on
	Battery status		Bluetooth on
	Data transfer in attaching		New SMS
	Data transfer in progress		New MMS
	Silent mode		Missed voice call
	Meeting mode		Missed video call
	Headset inserted		

### Shortcut for Menu

- In the main menu, press the corresponding **Alphanumeric Key** as shown on the menu below to access the corresponding menu.



- Press the corresponding **Alphanumeric Key** as shown before one option to quickly access the corresponding function.

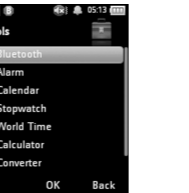

### Voice Call

1. In the standby mode, enter the phone number.
2. Press the **Send Key** to make a voice call.

### Video Call

1. In the standby mode, enter a phone number
2. Select **Options > Call > Video call** to make a video call.

### Text Input

1. Change input mode: Press **# Key** to choose input mode from the drop-down menu.
2. Change input language: Press **# Key** and choose the last option from the drop-down menu. Then select the language you need and press **OK Key**.
3. Input Letters: In abc/Abc/ABC mode, press the corresponding letter key till the letter appears.
4. Input Words: In En mode, key-in any letter with a single key pressing. Press each key only once for every letter. The phone will present a list of words based on the keys you pressed and its built-in dictionary. The word changes after each key stroke. When you have finished typing, move the cursor with **Navigation Keys** to choose the right word and confirm it by pressing **0** or **OK Key**.
5. Input Digits: In 123 mode, press a digit key once to enter a digit. In eZiEng mode, press the digit key, and select the number by pressing a Navigation key. In abc/Abc/ABC mode, constantly press the digit key until the number appears.
6. Input Symbols: Press **\* Key** to choose a symbol and **OK Key** to insert it into the text. In abc/Abc/ABC mode, press **1 Key** continuously till the required symbol (common symbols) appears.
7. Input Space: Press **0 Key** to input space. It does not work in 123 mode.
8. Delete Characters: Press **Clear Key** to clear a character. Press and hold **Clear Key** to delete all text before the cursor.
9. Move Cursor: Press **Navigation Keys** to move the cursor left, right, up, or down.

### Searching the Contact

In the **Contacts** interface, enter the first letter of the name you are searching for. Such as 'John', press the **5 Key** once for 'J'. All the names starting with 'J' are displayed.

Tip:  
Refine the search by entering more letters that can occur anywhere in the name.

### Sending SMS

#### Setting SMS

1. In standby mode, select **Menu > Messages > Settings > Text Msg. Settings**.
2. Set the related parameters. For more details, please contact your service provider.
3. Press the **OK Key** to complete.

#### Sending SMS

1. In standby mode, select **Menu > Messages > Create message**.
2. Enter the phone number(s) of the recipient(s). You can also select **Recipient** to add the receiver(s).
3. Press the **Down Key** to enter the **Text** field and edit the text.
4. Press the **OK Key** to send the SMS.

### Sending MMS

#### Setting MMS

1. In standby mode, select **Menu > Messages > Settings > Mul. Msg. Settings**.
2. Set the related parameters. For more details, please contact your service provider.
3. Press the **OK Key** to complete.

#### Sending MMS

1. In standby mode, select **Menu > Messages > Create message**.
2. Enter the phone number(s) of the recipient(s). You can also select **Recipient** to add the receiver(s).
3. Press the **Down Key** to enter the **Text** field and edit the text.
4. Select **Options > Insert > Sub** to edit the title.
5. Select **Options > Insert** to add the attachments (image, audio or video, etc.).
6. Press the **OK Key** to send the MMS.

### Sending an E-mail

#### Setting Mailbox

1. In standby mode, select **Menu > Messages**, press the **Right Key** to enter the Email interface, and then select **Settings > Mailbox Settings**.

2. You can edit or create the mailbox. For the details, please ask your mail service provider.
3. Press the **OK Key** to save your settings.

### Sending E-mail

1. In standby mode, select **Menu > Messages**, press the **Right Key** to enter the Email interface, and then select **New Email**.
2. Enter the recipient'(s) Email address. You can also press the **OK Key** to add the receiver(s) from the **Contacts**.
3. Press the **Down Key** to access **CC** field and enter the Email address of recipient(s).
4. Press the **Down Key** to edit the title.
5. Press the **Down Key** to access the **Text** field.
6. Edit the contents.
7. Press the **OK Key** to send the Email.

### Setting Network Connection

#### Checking and creating APN



Note:  
If there is no desired APN in the **Access point settings** menu, select **Options > Add** to create a new APN profile.

#### Setting the connection

1. In standby mode, select **Menu > Settings > Connections > Profile connect**
2. Press **Add** to create a new connection profile. Enter the necessary information and select the proper APN.



3. Press **Save** to finish.

### Activating the Proper Connection

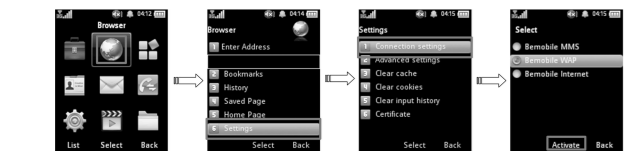

### Using Bluetooth

1. Enable the **Bluetooth** function.



2. Find the file which you want to send.  
Note: Select **Search For New Device** to scan the available device(s).  
3. Select the destination device, and follow the prompts to finish procedure.

### Viewing the Pictures

Additional features when you view one picture:

Feature	Function Key
Full Scn.	OK Key
Zoom in or out	Up o Down Key
Rotate the image	1,3 Keys

### Enjoying the Video

Additional features when you view one video:

Feature	Function Key
Volume up and down	Left and Right Keys
Brightness	2,8 Keys

### Streaming

In standby mode, select **Menu > Multimedia > Video > Streaming URL** to enter the streaming interface.  
TV channels are links to audio or video streaming content that are available through the browser (similar to bookmarks). The streaming content is only available while you are connected to the server, depending on your service provider or available content.

- If there is no Streaming URL list, press **Add** to add a new streaming file, input the **Title** and **URL** and then press the **OK Key** to save.
- In the Streaming URL list interface, press **Open** to open the URL, press **Options** for more options:

<b>New URL:</b> Create a new streaming URL.
<b>Edit:</b> Modify the selected URL.
<b>Send:</b> Send the selected URL via Message or Email.
<b>Delete:</b> Delete the selected URL.

<b>Delete all:</b> Delete all the URLs.
<b>Network settings:</b> Configure the network settings.
<b>Info.:</b> View the information about the selected URL.

### Using the Phone as Modem

If you activate data service function, your phone will be used as a modem. And the following steps are only for reference.

- Choose **USB** connection mode.

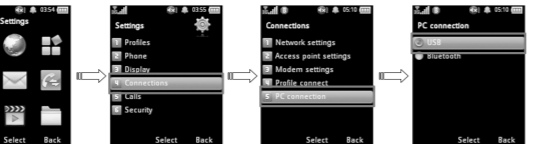

- Select **Menu > Settings > Connections > Modem settings** to set the related parameters, and then press **OK** to save your configuration.

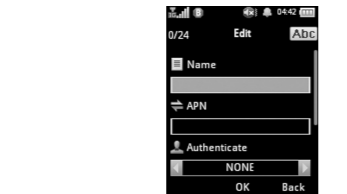

- Note:  
For the detail settings, please consult your service provider.
- Install and launch **Join Me** application software, and then click **Connect** to establish the connection between your phone and the software.
  - Click **Network**.
  - Click the **Connect** button to access to the Internet.

### Technical Parameters

Dimensions (L×W×H)	110 mm×47.5 mm×11.8 mm
Weight	Approx 70 g (including battery)
Display	2.0 inches 176*220 TFT
Back camera	0.3 M pixel camera
Extended memory	32 G microSD card
Battery	820 mAh, Lithium ion (Li-ion)
Continuous idle time	GSM: 200 hours; WCDMA: 330 hours
Continuous talk time	GSM: 240 minutes; WCDMA: 400 minutes
Continuous video talk time	135 minutes
Charge time	Approx 3 to 4 hours

Note:  
The phone's talk time and idle time are based on ideal working environments. The use of extended backlighting, browser, and network conditions can reduce battery life and talk/idle time.

### Safety Information

#### General Care

Your handset contains delicate electronic circuitry, magnets and battery systems. You should treat it with care and give particular attention to the following points:

- Do not allow the handset, battery or accessories to come into contact with liquids or moisture at any time. Do not immerse the handset in any liquid.
- Do not place the handset alongside computer disks, credit cards, travel cards and other magnetic media. The information contained on disks or cards may be affected by the handset.
- Do not paint the handset.
- Do not leave the handset or the battery in places where the temperature could exceed 60 °C, e.g. on a car dashboard or a windowsill, behind glass in direct sunlight, etc.
- Do not remove the handset's battery while the handset is switched on.
- Take care not to allow metal objects, such as coins or key rings to contact or short-circuit the battery terminals.

- Do not dispose of battery in a fire. The handset's Li-ION batteries may be safely disposed of at a Li-ION recycling point. Follow local requirements for recycling.
- Do not put the handset's battery in your mouth, as battery electrolytes may be poisonous if swallowed.
- Do not attempt to dismantle the handset or any of its accessories.
- Do not put a battery into a microwave oven, dryer, or high-pressure container.
- Do not contact battery directly to an electric outlet or cigarette lighter charger. Use only approved charger units.
- Do not pierce battery with a sharp object such as a needle.
- Do not disassemble or modify the battery.
- Do not use a damaged or deformed battery.
- Do not drop, throw, or subject the handset to rough treatment.
- Do not solder the battery directly.
- Stop using the battery if abnormal heat, odor, discoloration, deformation, or abnormal condition is detected during use, charge, or storage.
- Remove the battery whose life cycle has expired from equipment immediately.
- This equipment is fitted with an internal battery. Take it to a qualified service engineer when the replacement of the battery is required.
- The earpiece may become warm during normal use. Also, the handset itself may become warm while the battery is being charged.
- When a handset is in vibration mode, the vibration can sometimes cause the handset to move.
- Be careful not to place the handset near heat sources (such as a heater) or too close to the edge of the table.
- Power off your phone before you clean it. Use a damp or anti-static cloth to clean the handset. Do not use an ordinary dry cloth or electrostatic cloth. Do not use chemical or abrasive cleaners as these could damage the casing.
- Remember to make backup copies of all important data on your handset.
- Remember to recycle: the cardboard packing supplied with this handset is ideal for recycling.

Warning: In the unlikely event of a battery leak, take care to keep the battery discharge away from your eyes or skin. If the leakage does come into contact with the eyes or skin, please flush thoroughly in clean water and consult with a doctor.

### General Guidelines

- In some countries, national law prohibits private copying of copyrighted material. Please check the national legislation of the applicable country concerning the use of such material.
- Many jurisdictions have laws and regulations about taking pictures in public or private areas and regarding the processing and further use of such pictures. The manufacturer encourages its customers to obey all laws and to respect the personal rights of others.
- Please check roaming agreement availability with your service provider.
- The use of mobile phones is not allowed in some radiation sensitive areas, such as hospitals, research centers and airplanes. The user is responsible to power-off the device. If there is any uncertainty, you should remove the battery from the handset.
- Observe any signs that indicate powering off handsets, such as those near gas stations, or explosives, and power off the handset/device immediately.
- If you have a heart condition, be careful with the settings of call vibration or tone volume.
- Do not allow children to play with the handset, charger or batteries.
- Do not use the handset where blasting is in progress.
- Do not try to make a call or conversation while the temperature of charging battery is above 50°C.
- Take care not to put your handset in the back pocket of your trousers or skirt and then sit on it. Also, do not put your phone at the bottom of bag where it may subject to excessive weight or pressure. Doing so may damage the LCD and camera lens and cause them malfunction.
- The operation of some medical electronic devices, such as hearing aids and pacemakers, may be affected if a handset is used next to them. Observe any caution signs and the manufacturer's recommendations.
- Do not leave the handset discharged or without a battery for a long time, otherwise some data may be erased.
- Your phone contains metal, which may cause you an itch, a rash or eczema depending on your physical condition.

### Road Safety

- You must exercise proper control of your vehicle at all times. Give your full attention to driving.

- Observe all of the recommendations contained in your local traffic safety documentation.
- Pull off the road and park before making or answering a call, if driving conditions require so. Check if local laws and/or regulations restrict the use of handsets while driving.
- You must not stop on the hard shoulder of a motorway to answer or make a call, except in an emergency.
- Power off your handset at a refueling point, such as a gas station, even if you are not refueling your own car.
- Do not store or carry flammable or explosive materials in the same compartment as the handset.
- Electronic systems in vehicle, such as anti-lock brakes, speed control and fuel injection systems are not normally affected by radio transmissions. The manufacturer of such equipment can advise if it is adequately shielded from radio transmissions. If you suspect vehicle problems caused by radio transmissions, consult your dealer and do not power on the handset until it has been checked by a qualified technician.

### Hospital Safety

- Power off your phone and remove the battery in areas where the use of handsets is prohibited.
- Follow the instructions given by the respective medical facility regarding the use of handsets on their premises.

### Emergency Service

- To make an emergency call in any country:
- Ensure that your handset is on and in service.
  - Press the **End Key** as many times as needed to clear the display and ready the device for calls.
  - Enter the official emergency number for your present location, for example, 112 (the international emergency number).
  - Press the **Send Key** to dial the number. Follow instructions received and do not end the call until told to do so.

When the (U)SIM card is not inserted, press **SOS** and then enter the official emergency number for your present location. Press the **Send Key** to dial the number.

- Notes:
- Tell the operator which service you require: Police, Ambulance, Fire Brigade, Coastguard or Mountain Rescue Service. Tell them where you are and remain stationary to maintain contact if possible.
  - Due to the nature of the cellular system, the connection of emergency calls cannot be guaranteed. You should never rely solely on any wireless device for essential communications like medical emergencies.

### Third Party Equipment

The use of third party equipment, cables or accessories, not made or authorized by ZTE, may invalidate the warranty of your handset and also adversely affect the phone's safety/operation.

### Radio Frequency (RF) Energy

Your handset is a low-power radio transmitter and receiver. When powered on, it intermittently receives and transmits radio frequency (RF) energy (radio waves). The transmit power level is optimized for the best performance, and automatically reduces in the areas with better reception.

### Exposure to radio frequency energy

Radio wave exposure and Specific Absorption Rate (SAR) information:

- The handset is designed to comply with safety, requirements for exposure to radio waves. This requirement is based on scientific guidelines that include safety margins designed to assure the safety of all persons, regardless of age and health.
- The radio wave exposure guidelines employ a unit of measurement known as the Specific Absorption Rate, or SAR. Tests for SAR are conducted using a standardized method with the phone transmitting at its highest certified power level in all used frequency bands.
- While there may be differences between the SAR levels of various ZTE phone models, they are all designed to meet the relevant guidelines for exposure to radio waves.
- The SAR limit recommended by the International Commission on Non-ionizing Radiation Protection (ICNIRP) is 2.0 W/kg averaged over ten (10) grams of tissue.
- The highest SAR value for this model phone tested for use at the ear is 0.935 W/kg (10g).

### Vehicles Equipped with an Airbag

An airbag inflates with great force. Do not place objects, including either installed or portable wireless equipment, in the area over the airbag or in the airbag deployment area. If in-vehicle wireless equipment is improperly installed and the airbag inflates, serious injury could result.

### Aircraft Safety

- Power off your phone before the airplane takes off. In order to protect airplane's communication system from interference, it is prohibited to use mobile phone in flight. If you want to use mobile phone before the airplane takes off, you should get aircrew's permission according to safety regulations.
- If the mobile phone has the function of automatic timing power-on, please check your alarm setting to ensure that your phone will not be automatically powered on during the flight.

### Privacy Information

Camera usage and photo/audio/video recordings carried out with the handset can offend the confidentiality of the subjects. The user therefore is held to respect legislation in confidentiality matter and remains the only responsible subject in case of eventual violations of the enforced norm.

### Copyright Notice

The video/audio recordings you make/download are protected by copyright laws. They are for personal use only and must not be otherwise used without the permission of the copyright owner.

### Limitation of Liability

ZTE shall not be liable for any loss of profits or indirect, special, incidental or consequential damages resulting from or arising out of or in connection with using this product, whether or not ZTE has been advised, knew or should have known the possibility of such damages. Refer to the enclosed warranty card for full warranty and service information.