

INTERFACE ICONS

- Signal strength
- Roaming
- Incoming message
- Keypad locked
- Silent
- Alarm clock set
- Battery status

(*no space for messages when blinking)

BATTERY

The lithium ion battery of the mobile cellphone can be immediately used after unpacking.

INSTALLING THE BATTERY

- Remove the battery cover.
- Insert the battery by aligning the gold-coloured contacts with the contacts in the battery slot.
- Push down the upper section of the battery until it clicks into place.
- Replace the battery cover and close it gently until you hear a click.

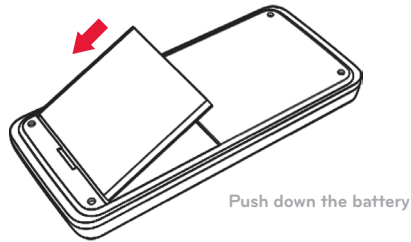

Push down the battery

REMOVING THE BATTERY

- Make sure that your cellphone is switched off.
- Remove the battery cover.
- Pull the battery up and remove it from the cellphone.

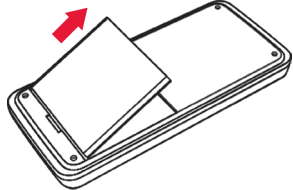

*Note: The correct way to remove the battery cover varies with the model of the cellphone. Please refer to the following diagrams.

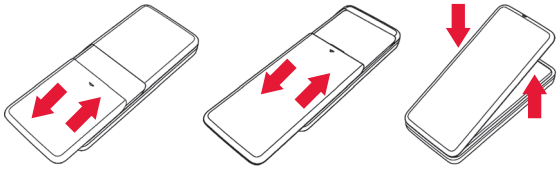

Note: In this User Manual, 'press a key' means to press the key and 'hold a key' means to hold the key for at least two seconds and then release it. To lock/unlock the keypad, press the # key and then the * key.

FUNCTION	DESCRIPTION
Left soft key	Performs the function indicated at the bottom left of the screen.
Right soft key	Performs the function indicated at the bottom right of the screen.
Centre key	To confirm actions and make selections.
4-Way Navigation keys (UP, DOWN, LEFT and RIGHT)	These keys allow for navigation through menu options and quick access to some function menus.
Navigation keys	You can customise the fast key settings of 4-Way Navigation keys in the standby mode.
Send key	Dial a phone number or answer a call, or view the call history.
End/Power key	Press to exit to the standby mode. Hold to switch to the cellphone on/off.
Alphanumeric keys	Enter characters 0-9 and the letters from a-z.

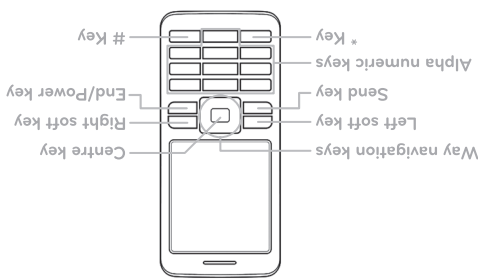

KEY FUNCTIONS

ZTE shall not be liable for any loss of profits or indirect, special, incidental or consequential damages resulting from or arising out of or in connection with using this product, whether or not ZTE has been advised, knew or should have known the possibility of such damages. The user should refer to the enclosed warranty card for full warranty and service information.

Note: The pictures and icons shown in the manual are just schematic drawings for function demonstration. If they are inconsistent with your cellphone, please take your cellphone as the standard. If an inconsistency exists in the manual because of the cellphone function updating, please refer to the follow-up public information from ZTE CORPORATION.

LIMITATION OF LIABILITY

Warning: If the battery is damaged, do not discharge it. If the leakage does come into contact with the eyes or skin, wash thoroughly in clean water and consult a doctor.

As your cellphone can produce an electromagnetic field, do not place it near magnetic items such as computer disks, telephones, radio and personal computer can cause interference. Using the cellphone near electrical appliances such as TV, refrigerator, air conditioner, etc. may cause interference. Do not dispose of it in accordance with environmental regulations. Do not dispose of it in household rubbish.

Please use original batteries or batteries approved by the cellphone manufacturer. Using any unauthorised battery may affect your cellphone's performance or may cause danger of explosion, etc.

HOW TO INSERT THE SIM CARD

You want a cellphone that is sophisticated yet easy to use and here it is in your hands! Naturally you are eager to start using it, but first you need to insert the SIM card.

Insert the SIM card as follows:

- Make sure that the cellphone is switched off and the charger is disconnected from the cellphone.
- Turn the cellphone over and remove the battery cover.
- Remove the battery if it is already installed.
- Hold your SIM card with the cut corner oriented as shown and then slide it into the card holder with the gold-coloured contacts facing downwards.
- Replace the battery first.
- Replace the battery cover.

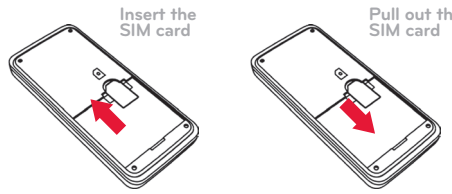

WHAT IS A SIM CARD?

Every cellphone has a SIM card (Subscriber Identity Module). This is a microchip that holds your personal information such as names and phone numbers. Your cellphone will not work without it. If you already have contacts on your SIM card, they can be transferred in most cases.

HOW TO CHARGE THE BATTERY

Your cellphone is powered by a rechargeable battery. For maximum battery performance, it is recommended that you first use up the battery power and then charge it completely. A new battery's full performance is achieved only after three complete charge and discharge cycles.

- Connect your travel adapter to the side of your mobile cellphone as shown in the diagram. Note: The side with the arrow should be upright while connecting.
- Connect the other end of the travel adapter to the mains socket.
- If you charge the battery, the battery indicator appears with the bars moving from right to left.
- When the battery is fully charged, disconnect the charger.

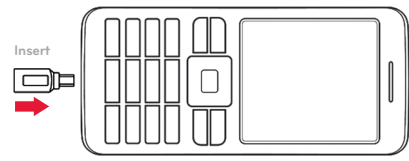

POWERING ON/OFF YOUR CELLPHONE

Make sure that your SIM card is in your cellphone and that the battery is charged. Please hold the End/Power key to power on/off the cellphone. The cellphone will automatically search for the network.

- Do not short-circuit the battery, as this can cause the unit to overheat or ignite.
- Do not store the battery in hot areas or throw it into fire, as it will cause an explosion.
- Do not take apart or refill the battery, as it will cause liquid leakage, overheating, explosion and ignition of the battery.
- Please store the battery in a cool dry place if you do not use it for a long period.
- The battery can be recharged hundreds of times, but it will eventually wear out. When the operating time (talk time and standby time) is short, the battery should be replaced.

BATTERY USE

- Do not store the battery in hot areas or throw it into fire, as it will cause an explosion.
- Do not take apart or refill the battery, as it will cause liquid leakage, overheating, explosion and ignition of the battery.
- Please store the battery in a cool dry place if you do not use it for a long period.
- The battery can be recharged hundreds of times, but it will eventually wear out. When the operating time (talk time and standby time) is short, the battery should be replaced.

AIRCRAFT SAFETY

- When using your cellphone near pacemakers, please always keep the cellphone more than eight inches (about twenty centimetres) from the pacemaker when the cellphone is switched on. Do not carry the cellphone in the breast pocket. Use the ear opposite the pacemaker to minimise the potential for interference. Switch off the cellphone immediately if necessary.
- Some cellphones may interfere with some hearing aids. In the event of such interference, you may consult your hearing aids manufacturer to discuss alternatives.
- If you use any other personal medical device, please consult the manufacturer of your device to determine if it is adequately shielded from RF energy.
- In those facilities with special detection, such as hospital or healthcare facilities, please pay attention to the restriction on the use of mobile cellphones. Switch off your cellphone if required.

SAFETY AND GENERAL USE IN VEHICLES

- Some electronic devices are susceptible to electromagnetic interference sent by mobile cellphone if inadequately shielded, such as electronic systems of vehicles. Please consult the manufacturer of the device before using the cellphone if necessary.

PRECAUTIONS FOR ELECTRONIC DEVICES

- As your cellphone can produce an electromagnetic field, do not place it near magnetic items such as computer disks, telephones, radio and personal computer can cause interference. Using the cellphone near electrical appliances such as TV, refrigerator, air conditioner, etc. may cause interference. Do not dispose of it in accordance with environmental regulations. Do not dispose of it in household rubbish.
- Please use original batteries or batteries approved by the cellphone manufacturer. Using any unauthorised battery may affect your cellphone's performance or may cause danger of explosion, etc.

ATMOSPHERES

- As your cellphone can produce an electromagnetic field, do not place it near magnetic items such as computer disks, telephones, radio and personal computer can cause interference. Using the cellphone near electrical appliances such as TV, refrigerator, air conditioner, etc. may cause interference. Do not dispose of it in accordance with environmental regulations. Do not dispose of it in household rubbish.
- Please use original batteries or batteries approved by the cellphone manufacturer. Using any unauthorised battery may affect your cellphone's performance or may cause danger of explosion, etc.

WRITING TEXT

- Change input mode: Press the # key to change the input mode (input modes: Eng, *Abc, abc, ABC and 123).
- Input Letters: In *Abc/abc/ABC mode, press the corresponding letter key until the letter appears.
- Input Words: In Eng mode, input any letter with a single key press. Press each key only once for every letter. The word changes after each key stroke. Predictive text input is based on a built-in dictionary. When you have finished writing the word and it is correct, confirm it by pressing the O key or the Centre key. If the word is incorrect, press the Up/Down keys to view other matching words found in the dictionary. Pressing the Navigation keys moves the cursor.
- Input Digits: In 123 mode, press digit key once to input a digit. In Eng mode, press the digit key and select the number by pressing the Navigation keys. In *Abc/abc/ABC mode, constantly press the digit key until the number appears.
- Input Symbol: Press the *key to enter a symbol. In *Abc/abc/ABC mode, constantly press the *key until the required symbol (common symbols) appears.
- Selecting Template: Hold the *key to open Templates. Select the required template.
- Input Space: Press the O key to input space. It does not work in 123 mode.
- Delete Character: Press the Right soft key to clear a character. Hold the Right soft key to delete all characters and clear the display.
- Move Cursor to Left or Right: Press the Left/Right navigation keys to move the cursor to left or right.

*Note: Abc mode is only available for certain models.

HOW TO ADD PEOPLE TO YOUR CONTACTS

There are some numbers that you may want to call again and again, so it makes sense to add these numbers to your contact list. You can then access these numbers quickly and easily.

- Press Right soft key to choose [Contacts].
- Press Left soft key (Options) and then select Add new Contact.
- Enter the contact's phone number.
- Press Left soft key (OK) or Centre key, then enter a name and confirm by clicking Left soft key (OK) or Centre key again.
- You can also save a number right after you have made or received a phone call or a text message from someone who is not yet on your contacts list.
- To delete someone from your contacts list, first select the name, then press Left soft key (Options) and choose Delete.

HOW TO MAKE AND RECEIVE CALLS

The most basic way to make a call is to input the number in the standby mode and press the Send key. You can also make a call from the contact list.

- To call someone: Press Right soft key to choose [Contacts]. Use the Up/Down keys to find the name of the person you want to call. You can also type in the first letter of the name of the person you want to call, and press the Send key.
- To receive a call, press the Send key.
- To end a call, press the End/Power key.

Make sure that you are in an area with sufficient coverage to make calls. The strength of the network signal is indicated on the Status Bar of the screen.

HOW TO SEND AND RECEIVE MESSAGES

You can use your mobile cellphone to send and receive text messages.

- Go to Menu -> Messaging -> New message.
- Write your message. For more information on writing, see section 'Writing text'.
- Press the Left soft key [Options] and select 'Send to one' to send the message to one person. To send to more than one person, select 'Send to contacts' and select the names from the contact list.
- Enter the recipient's phone number or select from Contacts. Then select OK to send the message.

Upon receiving a message, the mobile cellphone indicates with ringtone, prompt, or a new message icon.

- Press the Left soft key [Select] to open the new message. You can also go to Inbox to read the message.
- Use the Up/Down keys to read the message.
- While the message is open, use the Left soft key [Options] to reply, delete, or forward the message. You can also call back the sender or extract the sender's number.

HOW TO SET YOUR CELLPHONE

You can adjust various settings of your cellphone.

- Phone settings: Select language, edit your own cellphone number, set fast key and select to turn on/off the automatic keypad locking function.
- Display settings: Select to turn on/off the light of screen's background.
- Clock settings: Set data and time, and data format.
- Security settings: Security features protect you from illegal use of your cellphone and SIM card.

Note: You need to insert the cellphone lock code to enter the security settings interface. The default lock code is 1234.

HOW TO SET YOUR ALARM

- Set alarm: Select Set alarm submenu, you can set the corresponding features of the alarm according to instructions: alarm type (if required), date, time and ringtone.
- List alarms: Select List alarms submenu, you can view, edit and delete the alarm clock's settings. You can also enable or disable the alarms.
- Clear all: Select Clear all to clear all the alarm clocks.
- Define rest day: Select Define rest Day to set or change rest days of a week. Workday alarm will not ring on the defined rest day(s).

HOW TO SET YOUR RADIO

- Go to Menu - tools - FM radio. Press the left/right centre keys to change the channels, and up/down keys to adjust the volume. To save the channel, go to Option - Save - Select, and choose Yes.

You do not require the earphones in order to listen to the radio. The quality of the radio broadcast is dependent on the coverage of the radio station in your area. The radio will be turned off when you have an incoming call and will resume once the call has ended.

- You can perform other functions such as sending and receiving SMSs while your radio is playing. While on the radio menu, press the Power key of your phone and the radio will continue in the background while you perform other tasks with your phone. If you want to stop the radio, enter the FM radio menu again and press the Right Soft key.

YOUR CELL C FM LIVE

WELCOME PACK

Legal Information
Copyright © 2009 ZTE CORPORATION

All Rights Reserved
Your mobile cellphone is made by ZTE CORPORATION. No part of this manual may be reproduced or transmitted in any form or by any means without prior written consent of ZTE CORPORATION.

Trademarks
ZTE and the ZTE logos are trademarks of ZTE CORPORATION.

Notice
The information in this manual is subject to change without notice. Every effort has been made in the preparation of this manual to ensure accuracy of the contents, but all statements, information, and recommendations in this manual do not constitute a warranty of any kind, expressed or implied. Please read the safety precautions carefully to ensure the correct and safe use of your mobile cellphone. For detailed information, refer to the section "Safety Precautions".

ZTE CORPORATION Address:
ZTE Plaza, Keji Road South, Hi-Tech Industrial Park, Nanshan District, Shenzhen, P. R. China
Postal Code: 518057
Website: http://www.zte.com.cn

Release: V1.0.0

SECURITY

To protect your cellphone from illegal use, take the security measures as follows:

- Set PIN codes of the SIM card
- Set cellphone lock code
- Set call restrictions

SAFETY PRECAUTIONS

This section includes some important information on safe and efficient operation. Please read this information before using the cellphone.

OPERATIONAL PRECAUTIONS

Please use your cellphone properly. When making or receiving a call,

PRECAUTIONS FOR MEDICAL DEVICES AND FACILITIES

When using your cellphone near pacemakers, please always keep the cellphone more than eight inches (about twenty centimetres) from the pacemaker when the cellphone is switched on. Do not carry the cellphone in the breast pocket. Use the ear opposite the pacemaker to minimise the potential for interference. Switch off the cellphone immediately if necessary.

MOBILE CELLPHONE

Please use original accessories or accessories approved by the cellphone manufacturer. Using any unauthorised accessories may affect your cellphone's performance, damage your cellphone or even cause danger to your body, and violate related local regulations about telecom terminals.

PRECAUTIONS WHILE DRIVING

Please pay attention to traffic safety. Check the laws and regulations on the use of your cellphone in the area where you drive. Always obey them. Do not use your cellphone in the area where you drive. Always obey them. Use hands-free function of the cellphone, if available.

PRECAUTIONS FOR MEDICAL DEVICES

When using your cellphone near pacemakers, please always keep the cellphone more than eight inches (about twenty centimetres) from the pacemaker when the cellphone is switched on. Do not carry the cellphone in the breast pocket. Use the ear opposite the pacemaker to minimise the potential for interference. Switch off the cellphone immediately if necessary.

MOBILE CELLPHONE

Please use original accessories or accessories approved by the cellphone manufacturer. Using any unauthorised accessories may affect your cellphone's performance, damage your cellphone or even cause danger to your body, and violate related local regulations about telecom terminals.

PRECAUTIONS FOR MEDICAL DEVICES

When using your cellphone near pacemakers, please always keep the cellphone more than eight inches (about twenty centimetres) from the pacemaker when the cellphone is switched on. Do not carry the cellphone in the breast pocket. Use the ear opposite the pacemaker to minimise the potential for interference. Switch off the cellphone immediately if necessary.